

Training Example PSC-Bridge

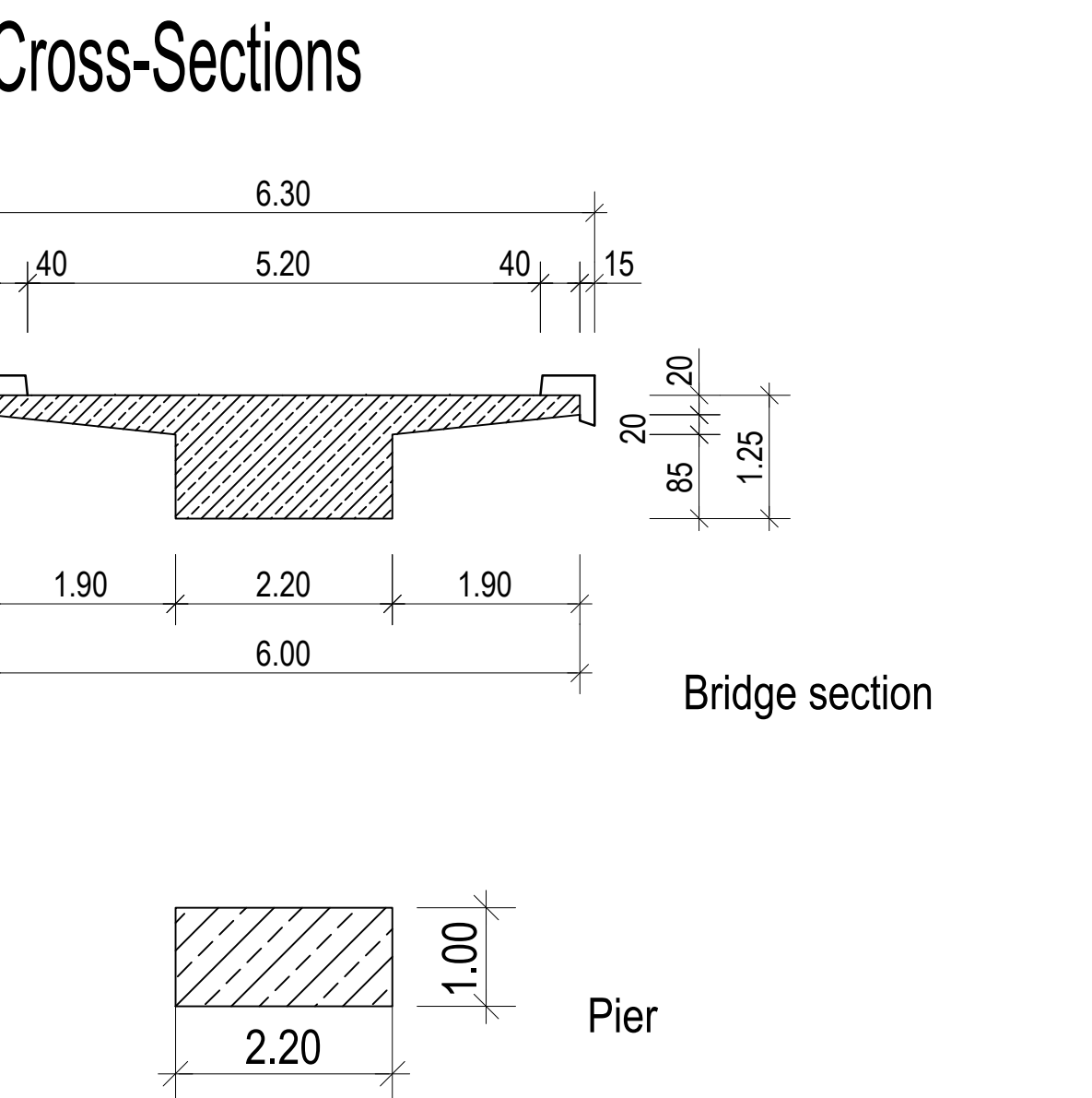
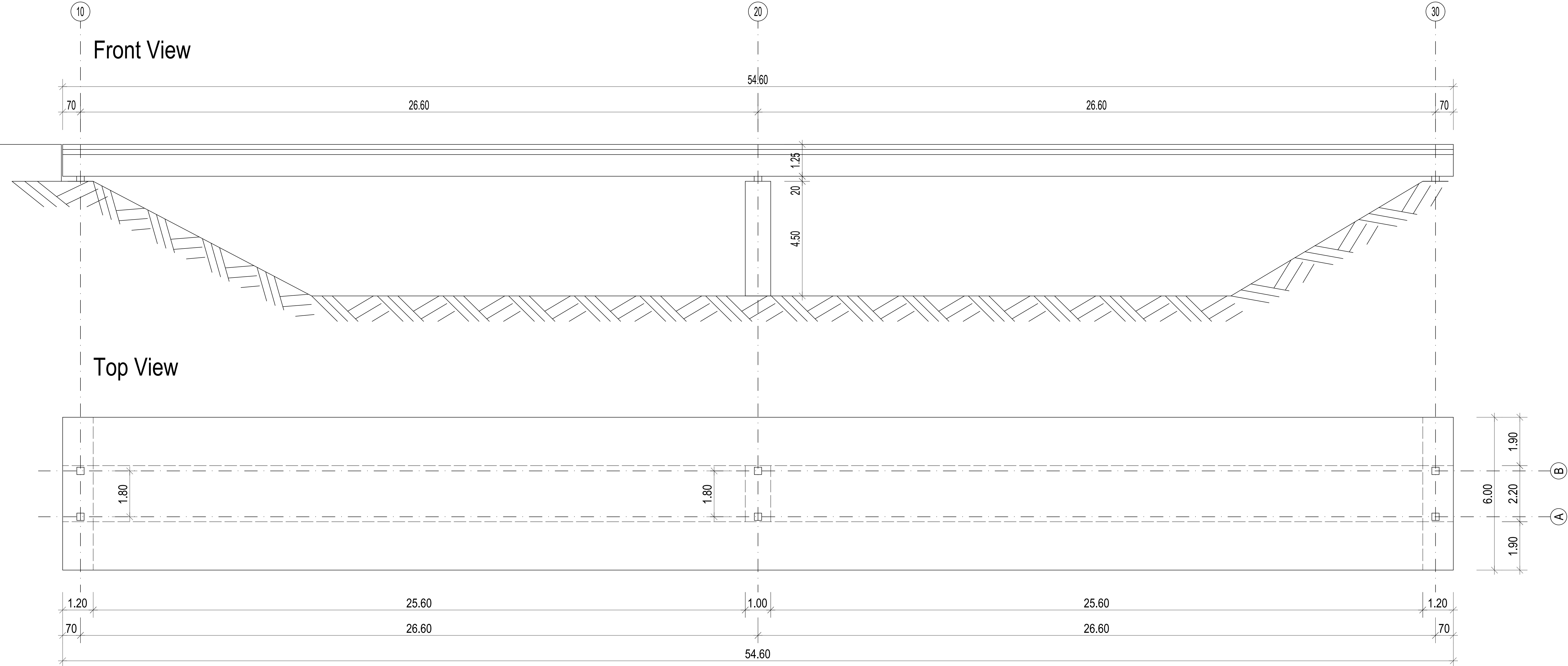

Materials	
Concrete Bridge	C 40/50
Concrete Pier	C 40/50
Reinforcement Steel	S 500
Prestressing Steel	Y 1770

Group Organisation	
pier	GRP 10
bridge deck	GRP 10

Cantilever/Spans [m]:	0.70	-	26.60	-	26.60	-	0.70
Stations [m]:	10.00	-	10.70	-	37.30	-	63.90 - 64.60

Actions		Load Cases		Construction Stages	
G_1	self weight	LC 1	self weight (automatic)	CS 10	self weight pier
G_2	additional dead load (adl)	LC 2	additional dead load - ADL (2,50 kN/m²)	CS 15	creep + shrinkage - pier only
T	temperature	LC 51-53	settlement support 10 to 30	CS 20	self weight of bridge deck
F	settlement	LC 91-98	temperature	CS 21	prestressing of bridge deck
P	prestressing			CS 25	creep + shrinkage
C	creep + shrinkage	LC 1201	load train load model LM1	CS 30	additional dead load - ADL (T 30000 RH 70 TEMP 20 NCRE 3)
GR_T	traffic load - tandem axis	LC 2xx	envelope "Traffic Loader", GR 1	CS 35	creep + shrinkage - traffic opening
GR_U	traffic load - udl			CS 45	creep + shrinkage - infinite